

INSTALLATION MANUAL

65746B

LED
BUILT IN



ADJUSTABLE



230V | SMD LED | 3W + 6W Backlight | IP20 | Aluminium

Complete with 700mA + 150mA drivers. With 2 x ON/OFF Switches.
Complete with black, brass & white reflectors.

90
CRI

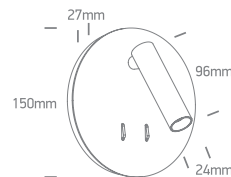
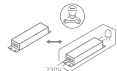

one
LIGHT

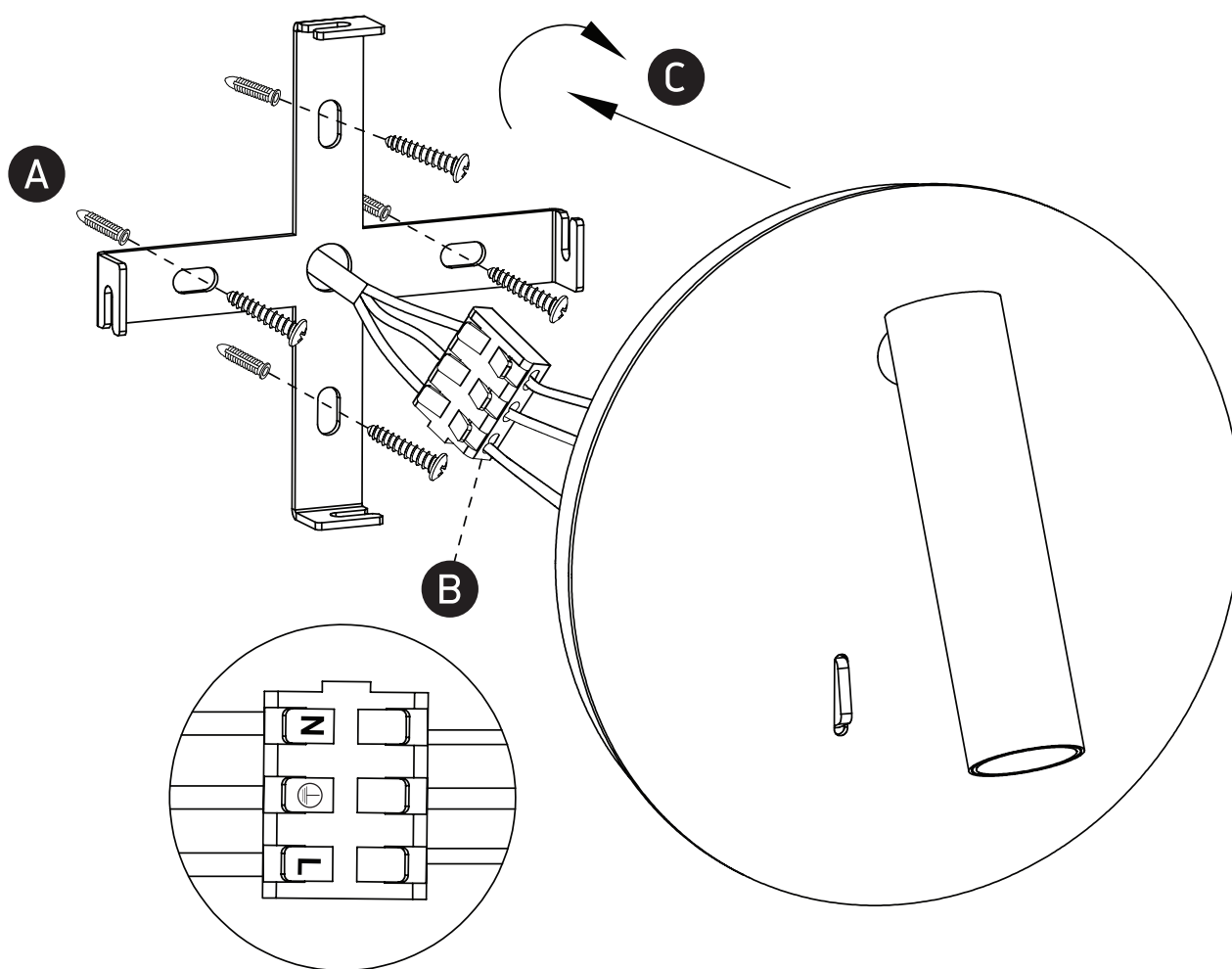

Warnings:

1. Make sure that the product is installed properly before connecting to electricity.
2. Do not cover the fitting.
3. Maintenance and installation should only be carried out by a professional electrician.

www.1-light.eu