

INSTALLATION MANUAL

38115LB/V, 38130LB/V, 38150LB/V

LED
BUILT IN



230V | SMD LED | CCT V | 15W / 30W / 50W | 50/60Hz | IP66 | PC
Complete with driver.

80
CRI

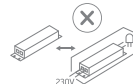

one
LIGHT

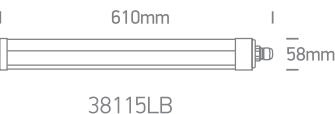

38115LB



38130LB



38150LB



62mm

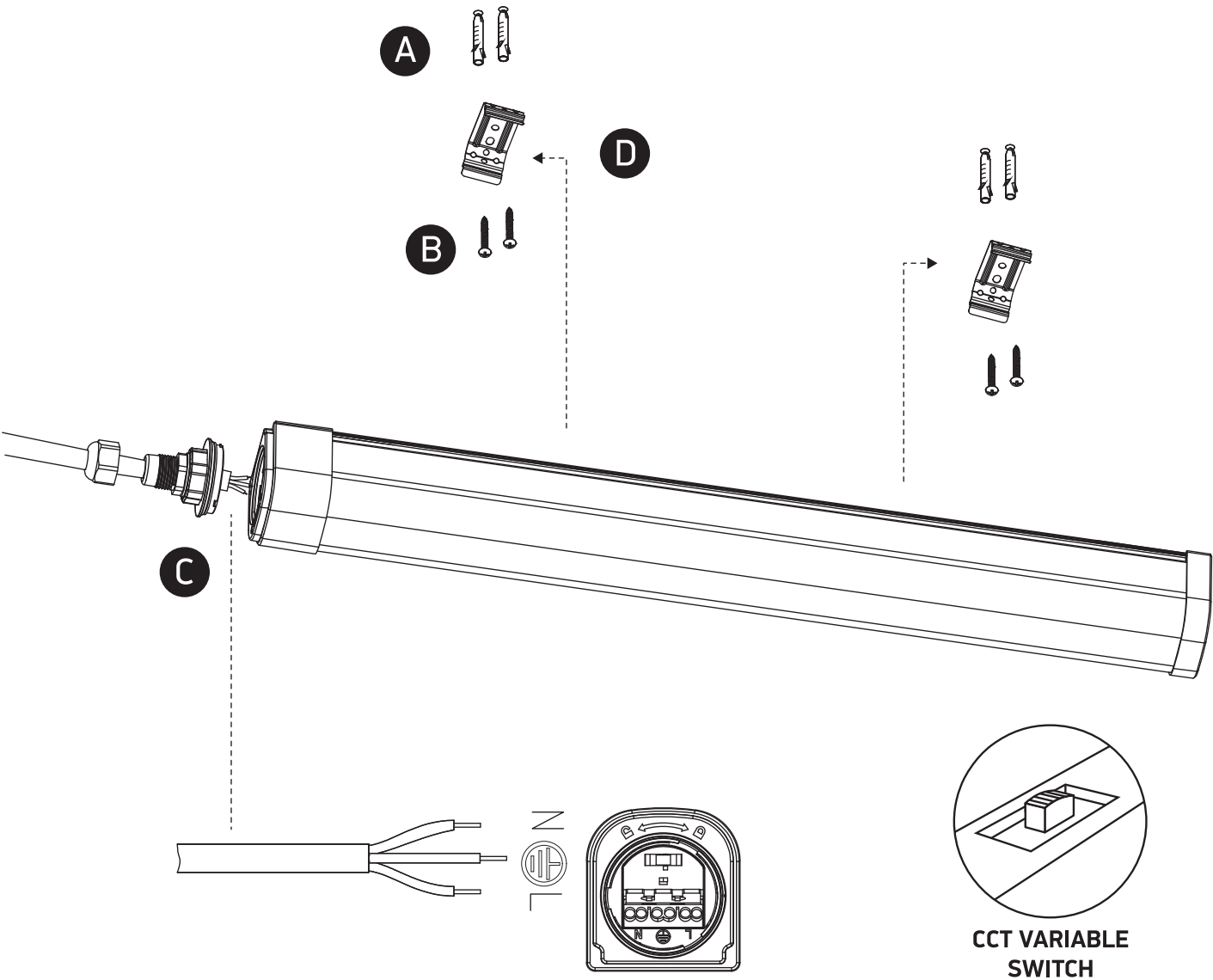

Warnings:

1. Make sure that the product is installed properly before connecting to electricity.
2. Do not cover the fitting.
3. Maintenance and installation should only be carried out by a professional electrician.