

# INSTALLATION MANUAL

38130LB

**LED**  
BUILT IN



**80**  
CRI

**CE ENEC UK CA**



230V | SMD LED | CCT V | 30W | 50/60Hz | IP66 | PC  
Complete with 230mA driver.

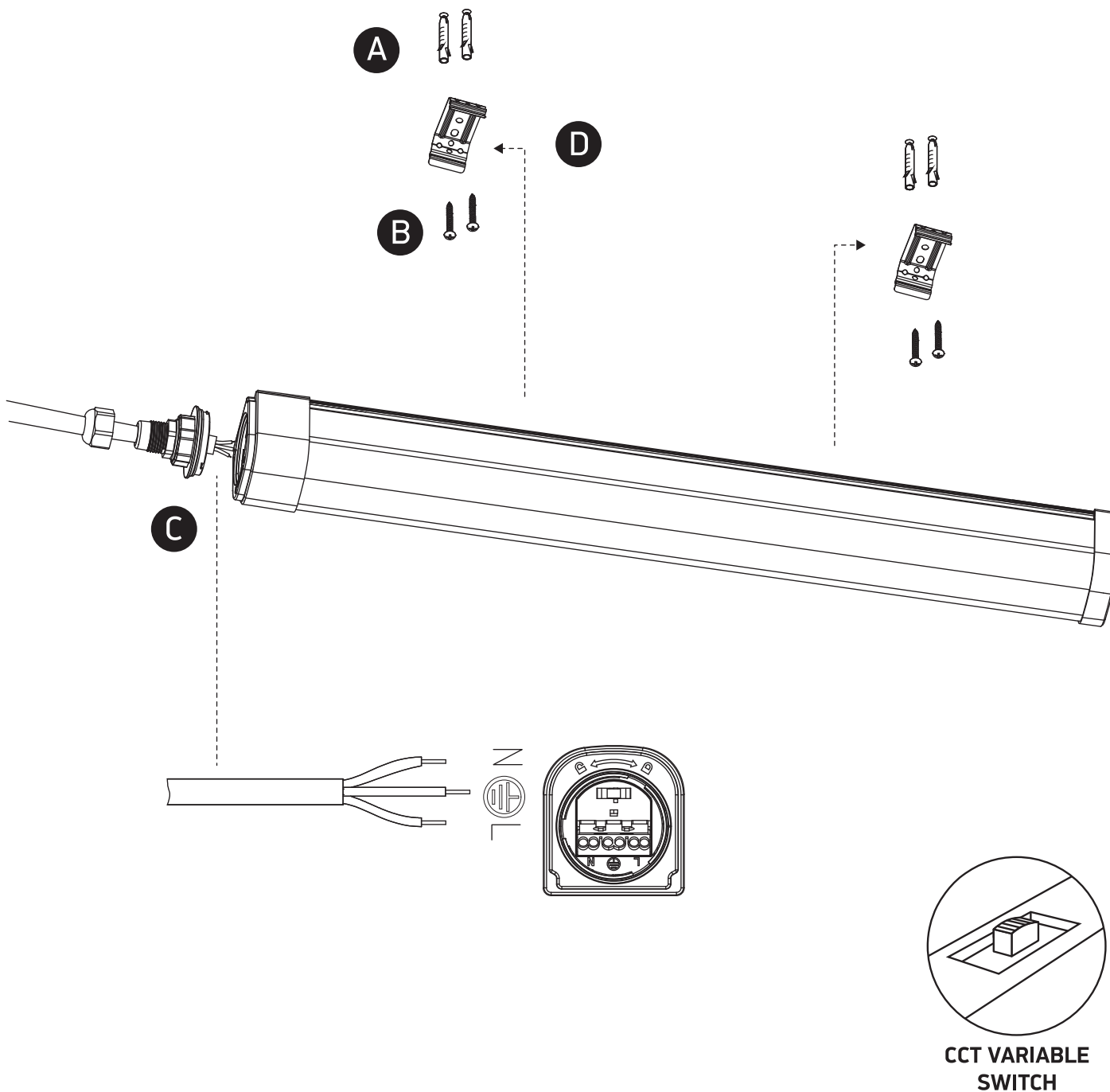
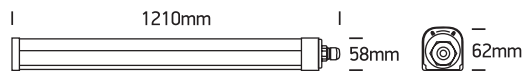

## Warnings:

1. Make sure that the product is installed properly before connecting to electricity.
2. Do not cover the fitting.
3. Maintenance and installation should only be carried out by a professional electrician.