

# INSTALLATION MANUAL

12125R

LED  
BUILT IN



CE ENEC UKCA

RoHS  
COMPLIANT



230V | COB | 25W | IP20 | Aluminium  
Complete with 650mA driver.

90  
CRI

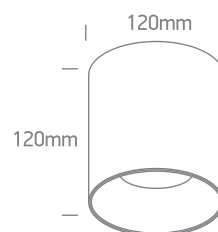
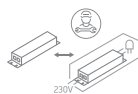

one  
LIGHT

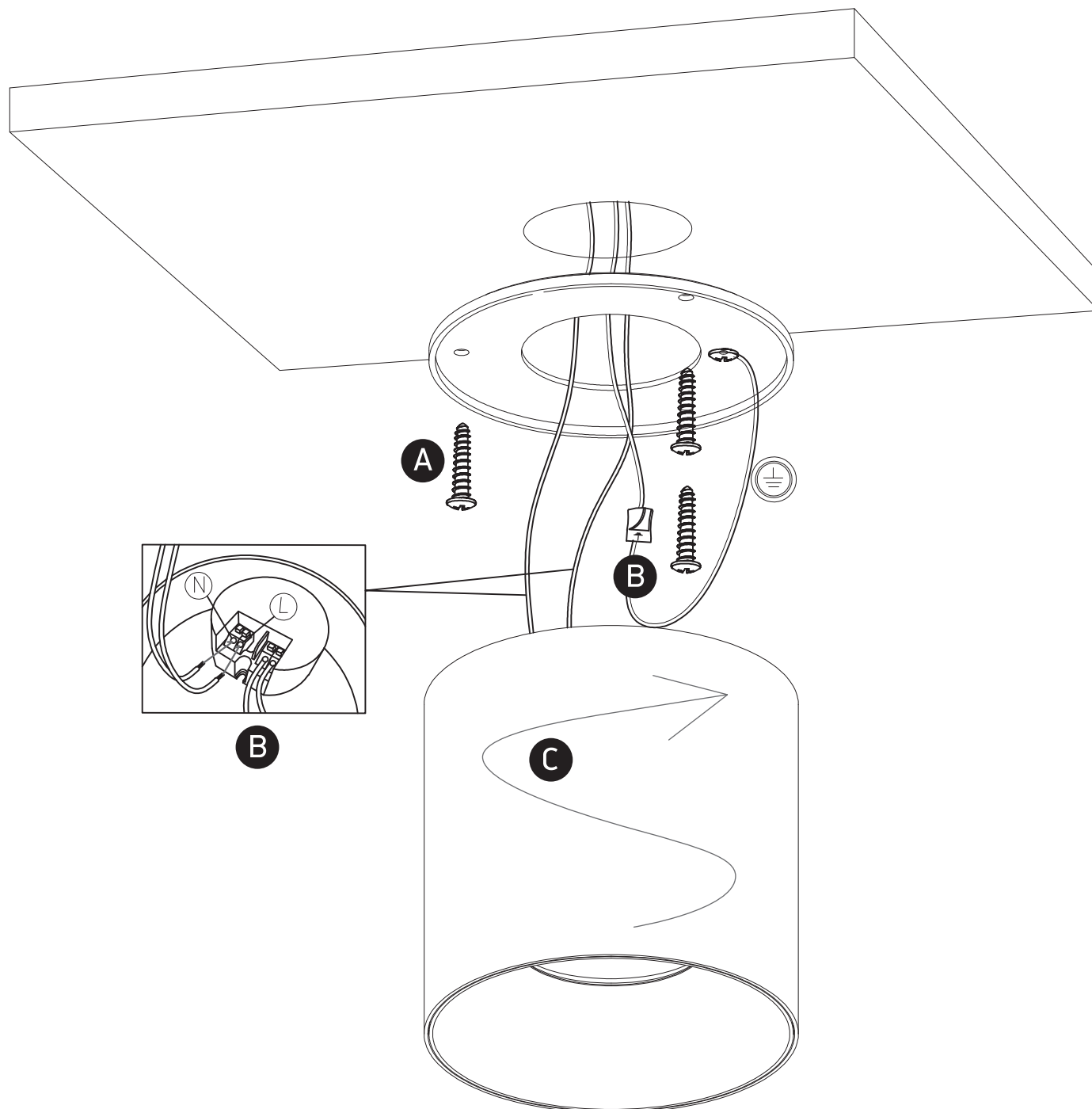

## Warnings:

1. Make sure that the product is installed properly before connecting to electricity.
2. Do not cover the fitting.
3. Maintenance and installation should only be carried out by a professional electrician.

[www.1-light.eu](http://www.1-light.eu)