

INSTALLATION MANUAL

10107T/./V

LED
BUILT IN



80
CRI

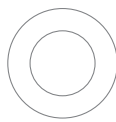

116mm



42mm

230V | SMD LED | CCT V | 7W | IP20 | Aluminium
Complete with 200mA driver.

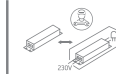

one
LIGHT

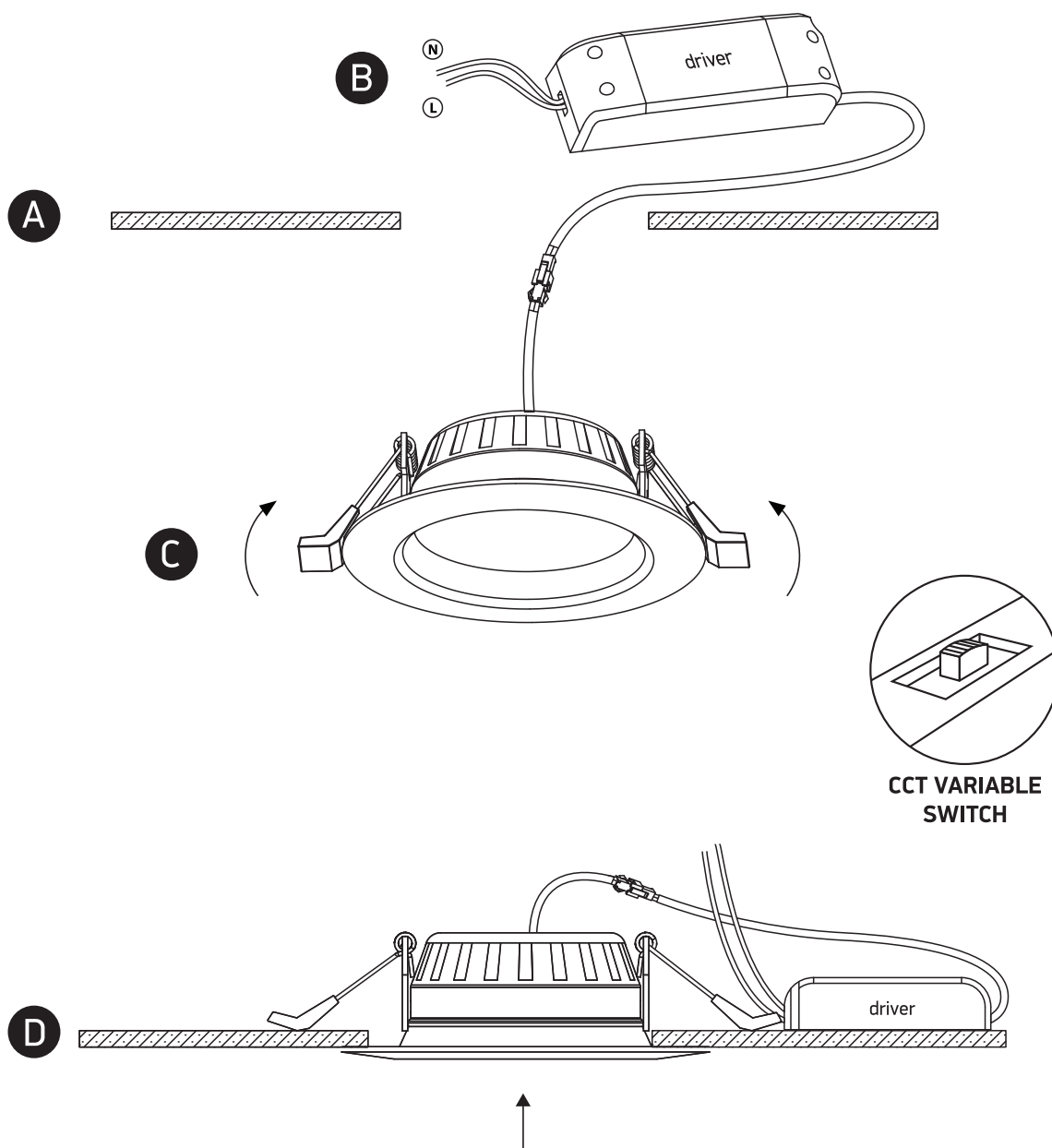

Warnings:

1. Make sure that the product is installed properly before connecting to electricity.
2. Do not cover the fitting.
3. Maintenance and installation should only be carried out by a professional electrician.