

# INSTALLATION MANUAL

10103J

**LED**  
BUILT IN



**DARK  
LIGHT**

**CE ENEC UK  
CA**

**RoHS  
COMPLIANT**



**NOT  
DIMMABLE**

230V | LED | 3W | IP20 | Aluminium  
Complete with 700mA driver.

**90  
CRI**

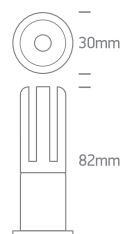
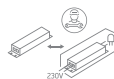

**one**  
LIGHT

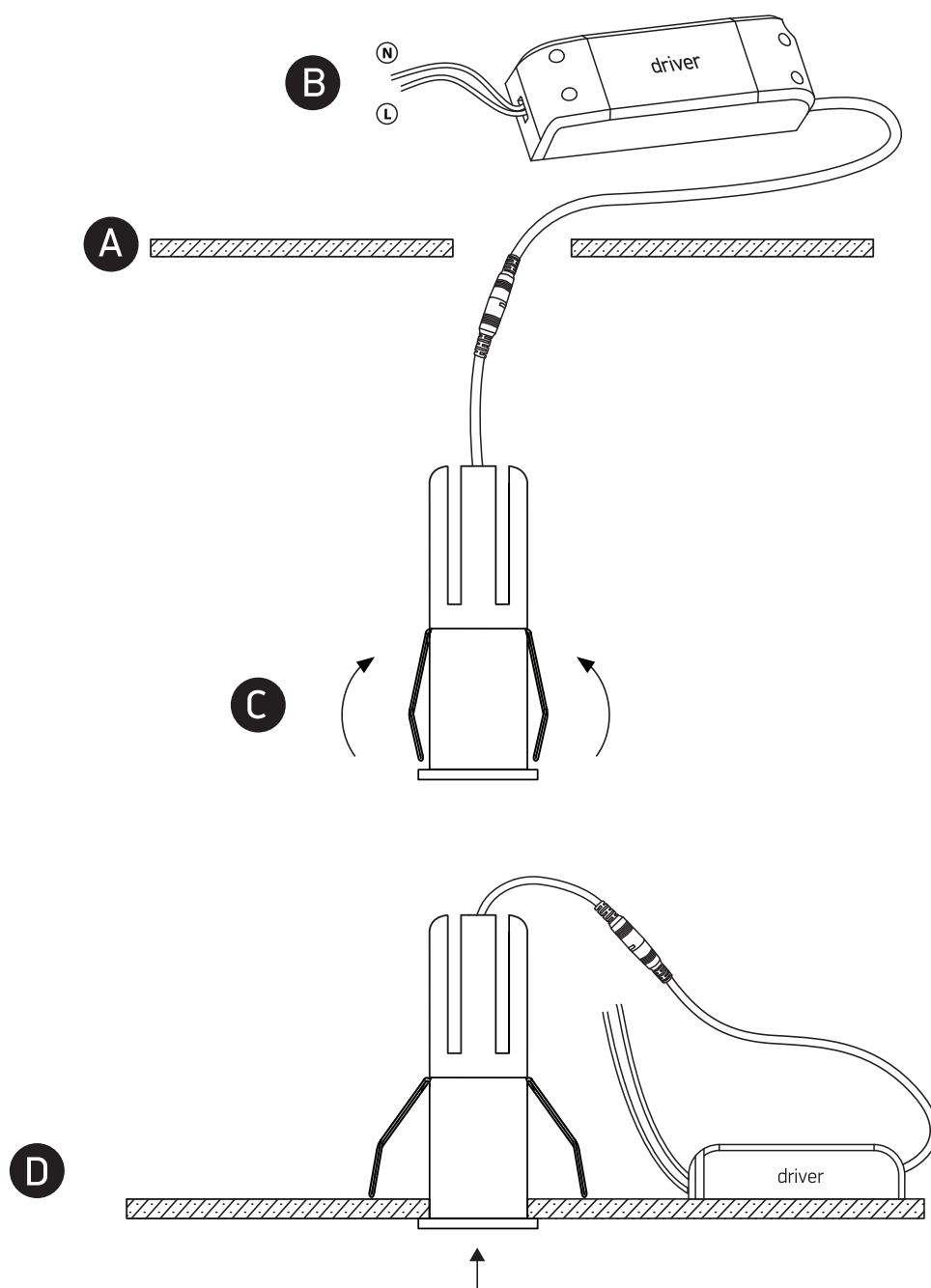

## Warnings:

1. Make sure that the product is installed properly before connecting to electricity.
2. Do not cover the fitting.
3. Maintenance and installation should only be carried out by a professional electrician.